

SCREW IN JACK RECEPTACLE
F. MOUNT - WITH CYLINDRICAL CONTACT-P500 **R141.561.161**
SERIES BNC-COM

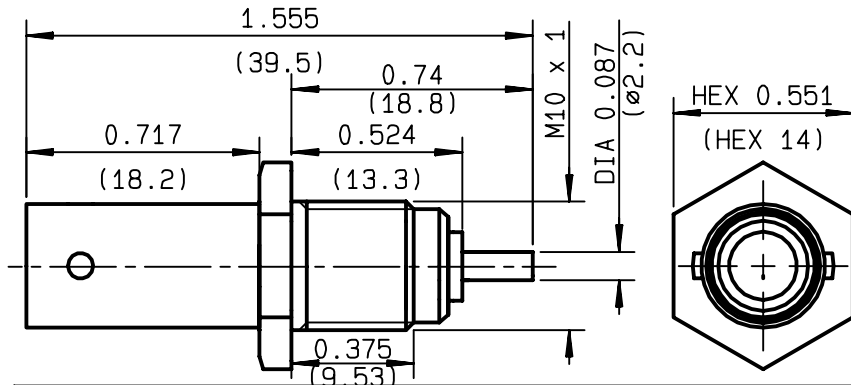

PERCAGE PANNEAU
 MOUNTING HOLE
 BOHRPLAN

A DEFINIR
 (TO BE DEFINED)
 (ZU BESCHREIBEN)

- * :Le couple de serrage de 400N.cm doit être appliqué sur un panneau en Aluminium ou en Laiton de 8mm minimum d'épaisseur.
- * :The 400N.cm coupling torque have to be put on a stainless steel or brass panel by 8mm minimum in thickness.
- * :Das Anzugsmoment von 400N.cm gilt nur fuer ein Gehaeuse aus Al oder CuZn mit einer Wandstaerke > 8mm.

NOMINAL IMPEDANCE	50 Ω
FREQUENCY RANGE	0-1.5 GHz
TEMPERATURE RATING	-35/+70 °C
V.S.W.R	1.08* + .006 x F(GHz)Maxi
RF INSERTION LOSS	.025* √F(GHz) dB Maxi
VOLTAGE RATING	500 Veff Maxi
DIELECTRIC WITHSTANDING VOLTAGE	1500 Veff Mini
INSULATION RESISTANCE	5000 MΩMini
HERMETIC SEAL	NA Atm.cm ³ /s
LEAKAGE (pressurized only)	NA
MECHANICAL DURABILITY	100 Cycles
WEIGHT	12.3 gr
SPECIFICATION	

CABLES :

OTHERS CHARACTERISTICS

*** Coaxial Transmission Line Only**

CABLE RETENTION	NA	N Mini
CENTER CONTACT RETENTION		
Axial force - mating end	15	N Mini
Axial force - opposite end	15	N Mini
Torque	NA	cm.N Mini
RECOMMENDED TORQUES		
Mating	NA	cm.N
Panel nut	*400	cm.N
Clamp nut	NA	cm.N

CONNECTOR PARTS	MATERIALS	FINISH	(all values are given in micrometers)
BODY	BRASS	NICKEL 2	
OUTER CONTACT			
CENTER CONTACT	BERYLLIUM COPPER	GOLD 0.2 OVER NICKEL 2	
INSULATOR	DELRIN (POM)	-	
GASKET		-	
OTHERS PIECES			

ISSUE	CREATION DATE	FILE PART-NUMBER
9913B00	08/02/1995	94-0104-924



ILLMER

The information given here is subject to change without notice. Design changes may be in order to improve the product.

Connect to the future